

AUTOSLIDE

AutoSlide Installation Preview

Instructions:

1. Print this sheet. Ensure that the five inch measurement below is correctly to scale.

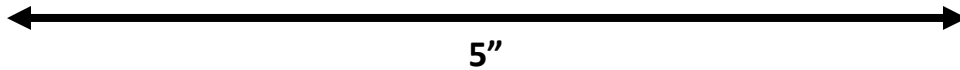

2. Cut out the AutoSlide unit body, track, and mounting bracket. Dotted lines mark mounting holes.

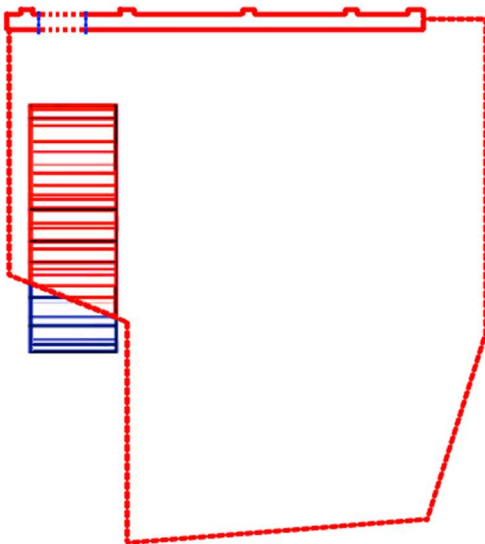

Unit body



Track

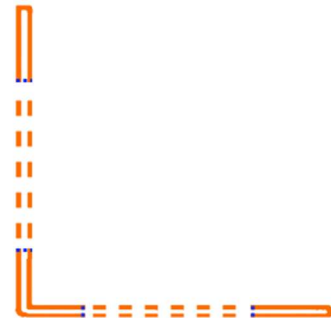

Mounting bracket

3. Hold the cutouts up to your sliding door to determine how it will mount.

- The track should vertically fully engage the motor wheel and horizontally be at least 50% engaged with the motor wheel. Reference examples below.
- The unit body must mount either to the mounting bracket or to a flat horizontal surface.
- The mounting bracket is optional and can be used to mount the unit body to a flat vertical surface.

Examples:

